



ILLINOIS MUSIC EDUCATION ASSOCIATION

## 2023 ILMEA Junior Festival Information for Students and Parents/Guardians

*Saturday, November 4, 2023*

Unity Junior High School

2115 S. 54th Ave.

Cicero, IL 60804

### Illinois Music Education Association District 1 Junior Festival

Congratulations on being selected to participate in the ILMEA District 1 Junior Festival on Saturday, November 4th, 2023 at Unity Junior High School in Cicero, Illinois. The festival will involve 390 students selected from more than 60 schools throughout the southwestern metropolitan Chicago area.

### Concert Schedule

The Festival Band, Orchestra, and Chorus will present their Festival Finale Concerts at the following times and locations: Band at 2:30 pm in the Gymnasium, Orchestra at 3:15 pm in the Gymnasium, and Chorus at 3:15 pm in the East Cafe. Spectators may enter through **Door 1**. **Parents: please do not enter the building prior to 2:00 PM**.

### Concert Ticketing

ILMEA District 1 ticketing is cashless. All concert tickets will be purchased through GoFan. Scan the QR code below to purchase tickets. You may also go to this website: <https://tinyurl.com/bdct5p8t>. Admission is \$6 (\$5 ticket price plus \$1 processing fee). ***You are highly encouraged to purchase tickets prior to the day of the concert - this will allow you to avoid long entry lines into the concert.*** The QR code will be available at the concert location should you need to scan it and purchase tickets onsite the day of the concert.



## **Parking for concerts**

Enter the parking lot from Laramie Avenue. There is parking available on the east, south, and west sides of the building. Additionally, there is space available in an “overflow” parking lot to the northeast of the building, just outside the district’s transportation center.

## **Student Preparation (Supplies needed and concert attire)**

Students, please make sure your music is prepared and performance-ready before you enter Unity Junior High on November 4th.

**All orchestra and band students should bring a portable music stand clearly marked with their name, along with a pencil.**

Dress for the concert is white OR black shirt and black pants/skirt. Please arrive dressed for the concert - there are no changing rooms available.

## **School Entry and Drop-Off**

Please enter through **Door 1**. All buses and parent drop offs will be coordinated through this entrance. Unity Junior High School staff and assistants will direct students to their initial rehearsal location. The building will be open for students and directors at 8:00 am - please do not arrive early as the facilities will not be available.

Students should report to the following locations upon arrival:

**Chorus:** East Cafe

**Band:** East Gym

**Orchestra:** West Cafe

## **Student Lunch**

Students may bring their own lunch or choose to purchase lunch on the day of the festival from Unity Junior High (see menu below).

### **Lunch Menu**

Combo #1: Cheese Pizza Slice, chips, drink, cookie: \$7.00

Combo #2: Turkey or Ham Mr. Sub Sandwich, chips, drink, cookie: \$10.00

Chips: \$1.00

Soda/Water: \$1.00

Candy: \$2.00

## **Festival Apparel and Plaques**

Allegro Apparel will be onsite at Unity Junior High in the Commons selling apparel and personalized plaques. Please see their information included at the end of this document.

## Student Schedule

Doors open at 8:00 am.

### Chorus

<b>9:00 – 9:45</b>	Rehearsal in <b>East Cafe</b>
<b>9:50 - 10:40</b>	Sectionals (see locations above)
<b>10:45 - 11:30</b>	Student lunch in <b>Commons</b>
<b>11:45 - 2:45</b>	Rehearsal in <b>East Cafe</b>
<b>2:45 – 3:15</b>	Prepare for concert
<b>3:15 – 3:45</b>	<b>Concert in East Cafe</b>

### Band Schedule

<b>9:00 - 10:40</b>	Rehearsal in <b>East Gym</b>
<b>10:45 - 11:35</b>	Sectionals (see locations above)
<b>11:45 - 12:30</b>	Student lunch in <b>Commons</b>
<b>12:30 - 2:10</b>	Rehearsal resumes in <b>East Gym</b>
<b>2:10 - 2:30</b>	Prepare for concert
<b>2:30 - 3:00</b>	<b>Concert in East Gym</b>

### Orchestra Schedule

<b>9:00 – 10:30</b>	Rehearsal in <b>West Cafe</b>
<b>10:30 - 10:40</b>	Transition to <b>West Gym</b>
<b>10:40 - 12:30</b>	Rehearsal in <b>West Gym</b>
<b>12:30 - 1:15</b>	Student lunch in <b>Commons</b>
<b>1:30 - 2:50</b>	Rehearsal in <b>West Cafe</b>
<b>2:50 - 3:15</b>	Prepare for Concert/Transition to <b>West Gym</b>
<b>3:15 - 3:45</b>	<b>Concert in West Gym</b>

# Map of Unity Junior High

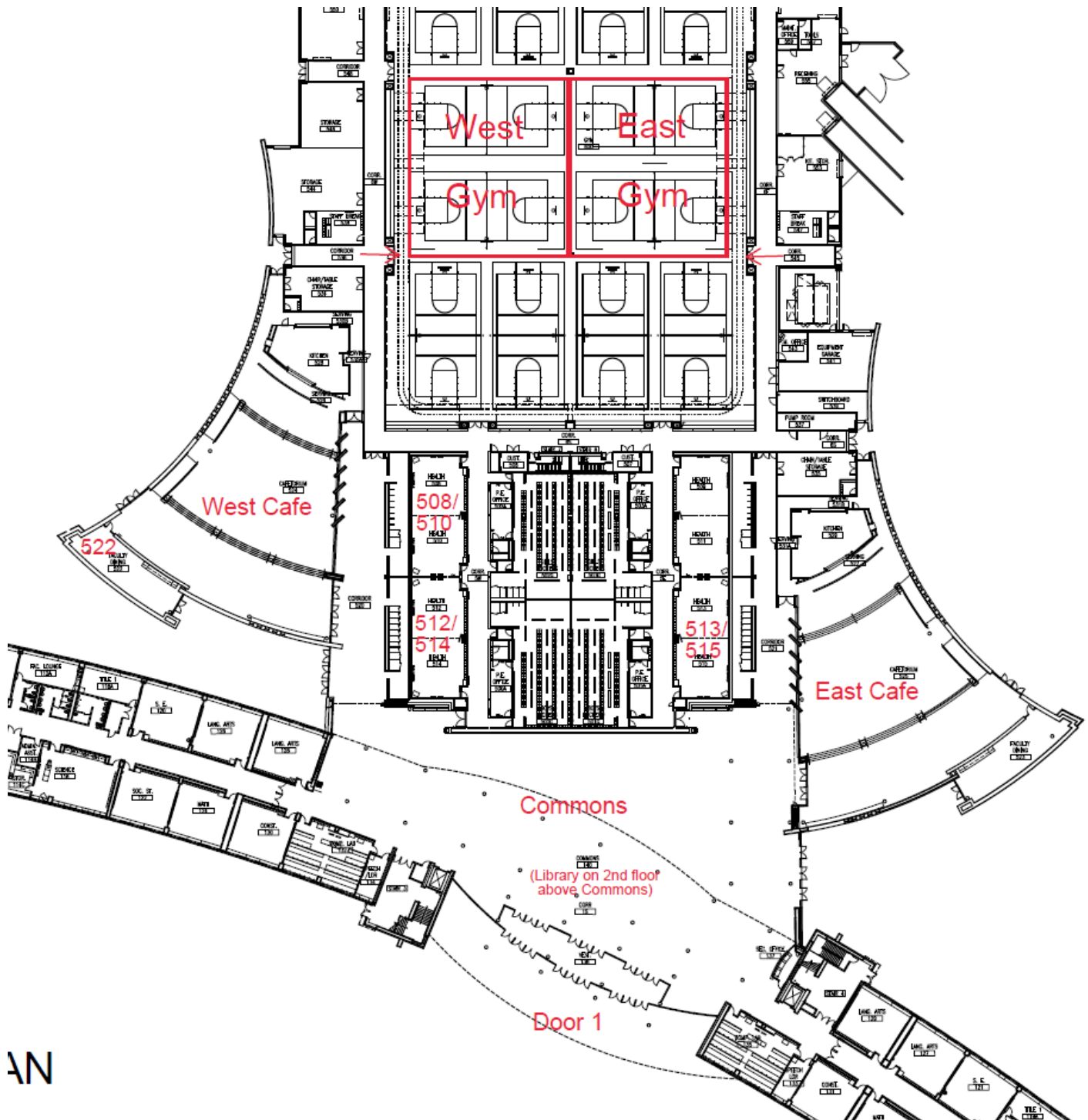

Directors and All District Participants -

Congratulations on your achievements! We are so excited for the upcoming District Festivals and want to share with you what is available this year.

Plaques, t-shirts and other items will be available for purchase in person at all Band, Orchestra and Chorus Festival sites. A plaque is created for every student, so no pre-ordering necessary. These items will be available at our online store as well, but shipping and handling will be added when purchased online. Events that we are not on-site, there will be no shipping charges, but a service/handling fee will be included.

The online store is open for all events, but you do not need to pre-order for pick up at the festival.

Our online store link is:

[2023/2024 Band, Orchestra and Choir ILMEA District Festivals – Allegro Apparel Online Store](#)

[2023 JAZZ ILMEA District Festivals – Allegro Apparel Online Store](#)

Note that there is an option in the store for directors to purchase individual plaques in quantity as well as Director's plaques listing all honored student musicians.

If you have any questions, feel free to contact us.  
And Congratulations! Your hard work has paid off!

Christy Silvas  
Allegro Apparel

[Christy@allegroapparel.com](mailto:Christy@allegroapparel.com)

682-472-5779



Directors Plaque  
8x10  
\$50



Student Plaque  
6x8  
\$25



District T-shirt  
ILMEA Logo on the front  
\$25



Students names on the back

\* 3% will be added to all credit card purchases